

Sunbeam

Burr Grinder

Automatic burr grinder with 17-position grind selector

Instruction Booklet

EM0430

Please read these instructions carefully
and retain for future reference.



Contents

Sunbeam's Safety Precautions	1
Features of your Sunbeam Burr Grinder	2
Using your Sunbeam Burr Grinder	4
Guidelines for 17-position grind fineness selector	8
Care and Cleaning	9

تأكد من تفهّم احتياطات السلامة المذكورة اعلاه

請務必理解上述的安全預防措施。

Assurez-vous que les précautions ci-dessus relatives à la sécurité sont bien comprises

Versichern Sie sich daß die obenstehenden Sicherheitsmaßnahmen Verstanden werden

Βεβαιώνετε πως οι παραπάνω προφυλάξεις ασφαλείας γίνονται κατανοητές

Pastikan bahwa tindakan-tindakan keselamatan seperti di atas dimengerti anda

Accertatevi che le suddette norme di sicurezza siano comprese a dovere

上記の注意事項をよくお読みになり、安全を御確認ください

Уверете се дека погоре споменатите мерки на претпазливост се добро разбрани

Asegúrese de que las precauciones de seguridad precedentes sean bien comprendidas

کاری بکنید کہ احتیاطهای بالا حتماً درک بشوند

ต้องแน่ใจว่า ข้อควรระวังเรื่องความปลอดภัยข้างต้น เป็นที่เข้าใจกันดี

Yukarda belirtilen güvenli̇k önlemlerinin anlaşıldığından emin olunuz

Xin kiểm chắc rằng những biện pháp làm an toàn kể trên được hiểu rõ

Sunbeam's Safety Precautions

SAFETY PRECAUTIONS FOR YOUR SUNBEAM BURR GRINDER.

- Check the grinding bowl for the presence of foreign objects before using.
- Always operate the grinder with the ground coffee container properly inserted in the grinder.
- When grinding make sure the lid of the ground coffee container is secured. If this lid is not securely in place, ground coffee can blow out of the grinder spout during grinding and create a mess on your benchtop.
- Do not place your hand in or near the burrs while the grinder is in operation.
- Always place the unit on a flat, level surface.
- Switch off and unplug at power point before cleaning.
- Do not attempt to re-grind ground coffee.

Sunbeam are very safety conscious when designing and manufacturing consumer products, but it is essential that the product user also exercise care when using an electrical appliance. Listed below are precautions which are essential for the safe use of an electrical appliance:

- Read carefully and save all the instructions provided with an appliance.
- Always turn the power off at the power outlet before you insert or remove a plug. Remove by grasping the plug - do not pull on the cord.
- Turn the power off and remove the plug when the appliance is not in use and before cleaning.
- Do not use your appliance with an extension cord unless this cord has been checked and tested by a qualified technician or service person.
- Always use your appliance from a power outlet of the voltage (A.C. only) marked on the appliance.
- Close supervision is necessary when your appliance is being used near children or infirm persons.
- Never leave an appliance unattended while in use.
- Young children should be supervised to ensure that they do not play with the appliance.
- Do not use an appliance for any purpose other than its intended use.
- Do not place an appliance on or near a hot gas flame, electric element or on a heated oven. Do not place on top of any other appliance.
- Do not let the power cord of an appliance hang over the edge of a table or bench top or touch any hot surface.
- For safety reasons and to avoid maintenance by unskilled persons, some appliances are 'sealed' using tamperproof screws. Such appliances should always be returned to the nearest Sunbeam Appointed Service Centre for adjustment or repair if required.
- Do not operate any electrical appliance with a damaged cord or after the appliance has been dropped or damaged in any manner. If damage is suspected, return the appliance to the nearest Sunbeam Appointed Service Centre for examination, repair or adjustment.
- For additional protection, Sunbeam recommend the use of a residual current device (RCD) with a tripping current not exceeding 30mA in the electrical circuit supplying power to your appliances.
- Do not immerse the appliance in water or any other liquid unless recommended.

If you have any concerns regarding the performance and use of your appliance, please visit www.sunbeam.com.au or contact the Sunbeam Consumer Service Line. Ensure the above safety precautions are understood.

Features of your Sunbeam Burr Grinder

Grinding bowl with lid

Coffee beans may be ground by pouring them directly into the grinding bowl, ideal when using alternative styles of beans and trialing new blends.

Burr grinding wheel

Removable burr grinding wheel for easy cleaning.

Grind fineness selector

17-position grind selector grinds beans to the correct fineness for espresso, drip, French Press and percolators.

Non-slip feet

Keeps the grinder stable on the benchtop during grinding.

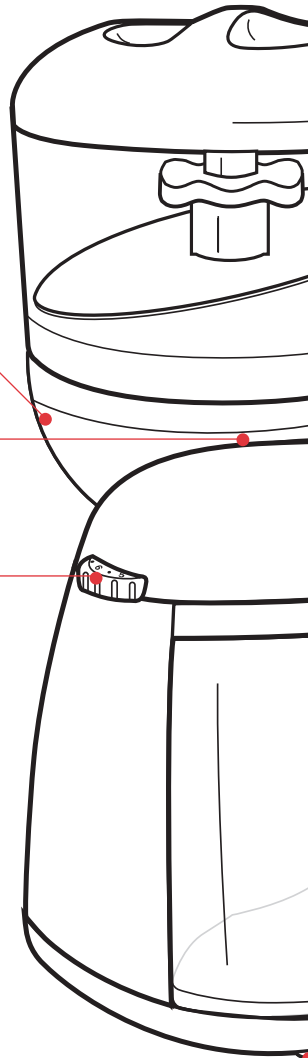

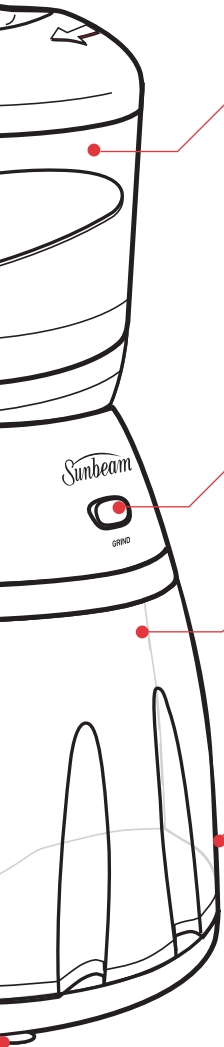

Portion-control container with lid

Allows you to grind the correct amount of beans for the required cups of coffee. Simply choose any amount of coffee from 2 to 16 cups and the beans are automatically dispensed into the grinding bowl. Also removable for storing beans inside.

Grind button

Once activated, the electronic bean sensor allows the grinder to continue grinding as long as there are beans in the grinding bowl, then stops automatically.

Ground coffee container

Large ground coffee container is easy to remove, making it simple for pouring out the coffee.

Illuminated On/Off power switch

Using your Sunbeam Burr Grinder

Before using your Sunbeam Burr Grinder, wipe the base exterior, grinding bowl and portion-control container clean with a damp cloth. Wash the grinding bowl lid, portion-control container lid and ground coffee container and its lid in warm soapy water. Allow to dry completely before use.

Note: Do not immerse the upper burr grinding wheel in water or any other liquid.

Note: Do not place any parts of the Sunbeam Burr Grinder in the dishwasher.

For first-time grinding

Important: During manufacturing, the upper burr grinding wheel is positioned so that it is very close to the lower burr grinding disk. To ensure the grinder performs properly, proceed as follows:

1. Place the Sunbeam Burr Grinder on a dry, level surface.
2. Check to make sure that the grinding bowl is free of any foreign objects and that it is completely clean and dry.
3. Set the grind fineness selector to number '9'.
4. Fill the grinding bowl with 3 to 4 scoops of coffee beans and position the grinding bowl lid to the bowl.
5. Plug the power cord into a 230-240V AC power outlet and switch the power on.
6. Turn the power switch on the Sunbeam Burr Grinder to 'ON', the switch will illuminate.

Note: Ensure that the lid on the grinding bowl is secure and in place.

7. Push the 'GRIND' button for 2 seconds and release. The Sunbeam Burr Grinder will grind all the beans in the grinding bowl, once empty it will then stop automatically.
8. Turn the power switch on the Sunbeam Burr Grinder to 'OFF'.
9. Remove the lid to the grinding bowl and fill bowl with 3 to 4 scoops of coffee beans. Replace the lid.
10. Set the grind fineness selector to number '4', this is to ensure that the upper burr grinding wheel is moving properly.
11. Turn the power switch on the Sunbeam Burr Grinder to 'ON'.
12. Push the 'GRIND' button for 2 seconds and release.

Note: Your Sunbeam Burr Grinder is now prepared to be used on a regular basis.

Grinding

1. Place the Sunbeam Burr Grinder on a dry, level surface.
2. Check to make sure that the grinding bowl is free of any foreign objects and that it is completely clean and dry.

Using your Sunbeam Burr Grinder (continued)

Using the portion-control container;

3. Ensure that the lid of the grinding bowl is removed.
4. Position the portion-control container directly on top of the grinding bowl. To lock into position turn the portion-control container clockwise, see figure 1.

Figure 1

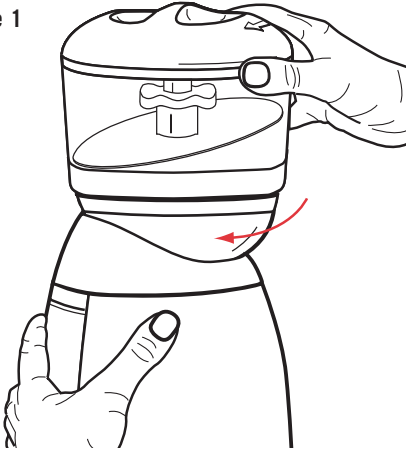

5. Pour coffee beans into the portion-control container and position the lid. Slowly turn the lid of the portion-control container, in a clockwise direction, with each turn or click enough beans for 2 cups of coffee are dispensed into the grinding bowl, see figure 2. The grinding bowl holds enough beans for up to 16 cups of coffee.

Figure 2

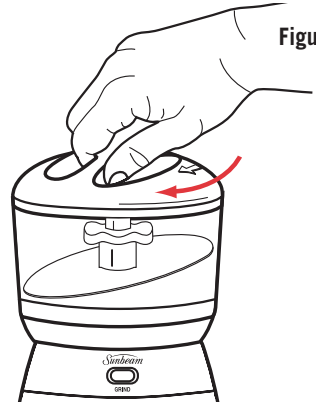

Using the grinding bowl

6. Alternatively coffee beans can be poured directly into the grinding bowl. Replace the lid.
7. Set the grind fineness selector, see figure 3.

Figure 3

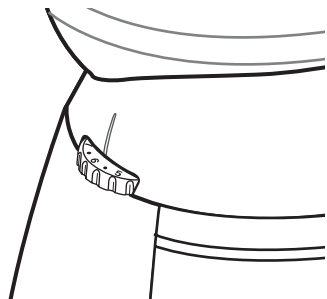

Using your Sunbeam Burr Grinder (continued)

8. Plug the power cord into a 230-240V AC power outlet and switch the power on.
9. Turn the power switch on the Sunbeam Burr Grinder to 'ON', the switch will illuminate, see figure 4.

Figure 4



Note: Ensure that the lid on the portion-control container or grinding bowl is secure and in place.

10. Push the 'GRIND' button for 2 seconds and release. The Sunbeam Burr Grinder will grind all the beans in the grinding bowl, once empty it will then stop automatically.

Note: Oily beans may stick together and not feed into the burrs. This can cause the automatic sensor to turn off the grinding action. Should this occur, just tap the housing of the Sunbeam Burr Grinder a few times to loosen up the beans and push the 'GRIND' button again to resume grinding.

11. While still positioned in the grinder, tap the ground coffee container a few times, this allows the ground coffee to settle down into the container. Now, slowly remove the container from the Sunbeam Burr Grinder, see figure 5. Before removing the lid to the ground coffee container, tap the container again a few times to settle more of the ground coffee, see figure 6.

Figure 5

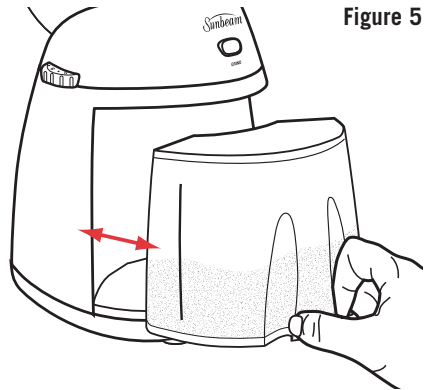
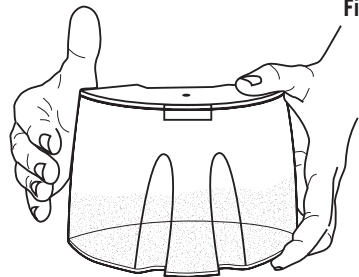

Figure 6



Using your Sunbeam Burr Grinder (continued)

12. Turn the power switch on the Sunbeam Burr Grinder to 'OFF', see figure 7.

Figure 7

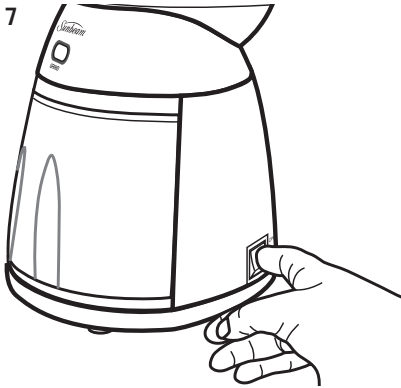

13. Once the ground coffee container is emptied, insert the empty ground coffee container with the lid securely in place back into the Sunbeam Burr Grinder.

Note: Allow the Sunbeam Burr Grinder to cool down for 5 to 10 minutes before grinding again.

Guidelines for 17-position grind fineness selector

The grind fineness selector gives you the choice of 17 positions, allowing you to find the perfect grind selection for a superb result in all styles of coffee machines.

Note: The finer you select the coffee grind to be, the longer it will take to grind.

Note: If you grind in the finer settings (settings from 1 to 3) we recommend cleaning the ground coffee spout and upper burr grinding wheel after each grinding session to avoid clogging. See the Care and Cleaning section on page 9 for more details.

Grind Fineness Selector	Suited Style of Coffee Machine
8 - 9	French Press Coffee Makers
	Percolators
4.5 – 6	Non-Pump Espresso (steam/boiler) Machines
3.5 – 5	Drip Coffee Makers
2.5 – 4	Pump Espresso Machines
1 – 2.5	Fully Automatic Coffee Centres

Note: The fineness settings are approximate guidelines. For pump espresso machines and automatic coffee centres, if your coffee or espresso brews too fast try a lower number setting than indicated above. If it brews too slowly, try a higher setting than the ones recommended above.

Care and Cleaning

Do not immerse the motor base of the Sunbeam Burr Grinder in water.

Do not place any parts of the Sunbeam Burr Grinder in the dishwasher.

1. When you have finished grinding, unplug the grinder from the power outlet.
2. Empty the ground coffee container.
3. The portion-control container and lid, the separate grinding bowl lid (if used) and the ground coffee container and its lid can be washed in warm soapy water. Rinse and dry thoroughly.
4. With the small brush (provided), brush away any ground coffee particles from the ground coffee spout (where the ground coffee comes out and into the ground coffee container), see figure 8.

Figure 8

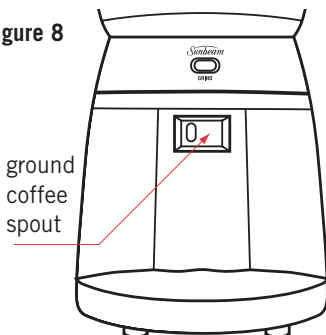

5. Wipe the base exterior and grinding bowl clean with a damp cloth.

Removing and cleaning the burr grinding wheel

Note: Do not immerse the upper burr grinding wheel in water or any other liquid.

6. Turn the grind fineness selector to number '1'.

7. Turn the upper burr grinding wheel in a clockwise direction until it stops, see figure 9.

Figure 9

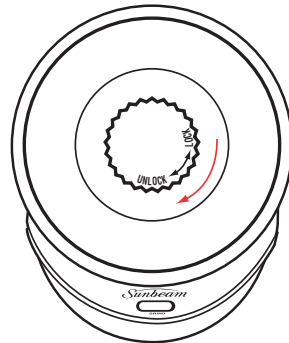

8. Lift the upper burr grinding wheel out of the grinding bowl. Clean both burrs with the small brush (provided).

Note: Do not unscrew the upper burr from its housing.

9. Replace the upper burr grinding wheel back into position in the grinding bowl and turn anti-clockwise until the grind fineness selector points to number '9', see figure 10.

Figure 10

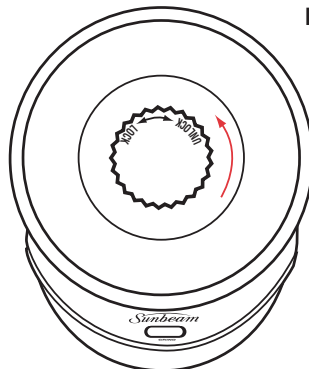

'Sunbeam', is a registered trademark of Sunbeam Corporation.

Made in China. Due to minor changes in design or otherwise, the product may differ from the one shown in this leaflet. Backed by Sunbeam's 12 Month Replacement Guarantee and National Service Network.

© Copyright. SUNBEAM CORPORATION LIMITED 2003.

(INCORPORATED IN N.S.W.) A.C.N. 000 006 771

Sunbeam Corporation is a division of GUD Holdings Ltd.

For more information or advice on this or any other Sunbeam appliance, visit www.sunbeam.com.au or contact the Sunbeam Consumer Service Line.

Australia 1800 025 059

New Zealand (09) 912 0747.

Sunbeam

Consumer Hotline

Australia

1800 025 059

New Zealand

(09) 912 0747

www.sunbeam.com.au

Sunbeam is a registered Trademark of Sunbeam Corporation Limited. ACN 000 006 771.

© Sunbeam Corporation Limited 2003.